

CURRENT LOCATION OF BUS STOP FOR OASIS AT BRIMSTONE HILL DR on RTE 41

CONTRACTOR TO MAINTAIN ACCESS TO ENT PHASES OF CONSTRUCTION (TYP.)
 ENTRANCE LOCATION DURING CONSTRUCTION
 DEPENDING ON REQUIRED WORK ZONE DETERMINED BY CONTRACTOR

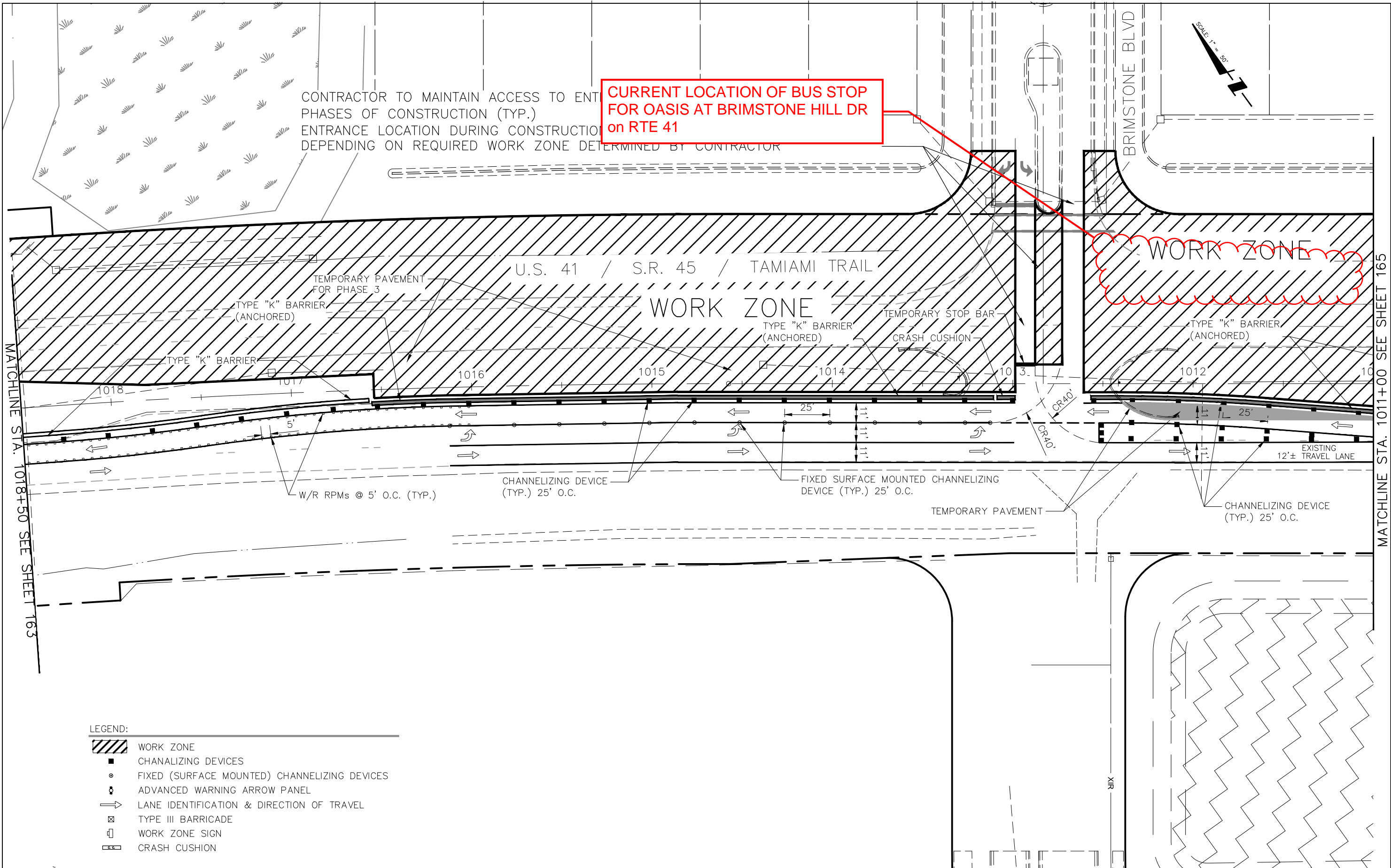
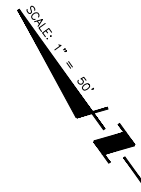

LEGEND:

- WORK ZONE
- CHANNELIZING DEVICES
- FIXED (SURFACE MOUNTED) CHANNELIZING DEVICES
- ADVANCED WARNING ARROW PANEL
- LANE IDENTIFICATION & DIRECTION OF TRAVEL
- TYPE III BARRICADE
- WORK ZONE SIGN
- CRASH CUSHION

REVISIONS		STANTEC CONSULTING SERVICES, INC. 6900 PROFESSIONAL PARKWAY EAST SARASOTA, FLORIDA 34240-8414 FBPE CERT. OF AUTH NO. 27013		STATE OF FLORIDA DEPARTMENT OF TRANSPORTATION		TEMPORARY TRAFFIC CONTROL PLAN PHASE 2	SHEET NO. 164	
DATE	DESCRIPTION	DATE	DESCRIPTION	ROAD NO.	COUNTY			FINANCIAL PROJECT NO.
				###	"SARASOTA COUNTY"			215616466
				KRISTOPHER A. WILHOIT, PE NO. 59549				

SCALE: 1" = 50'

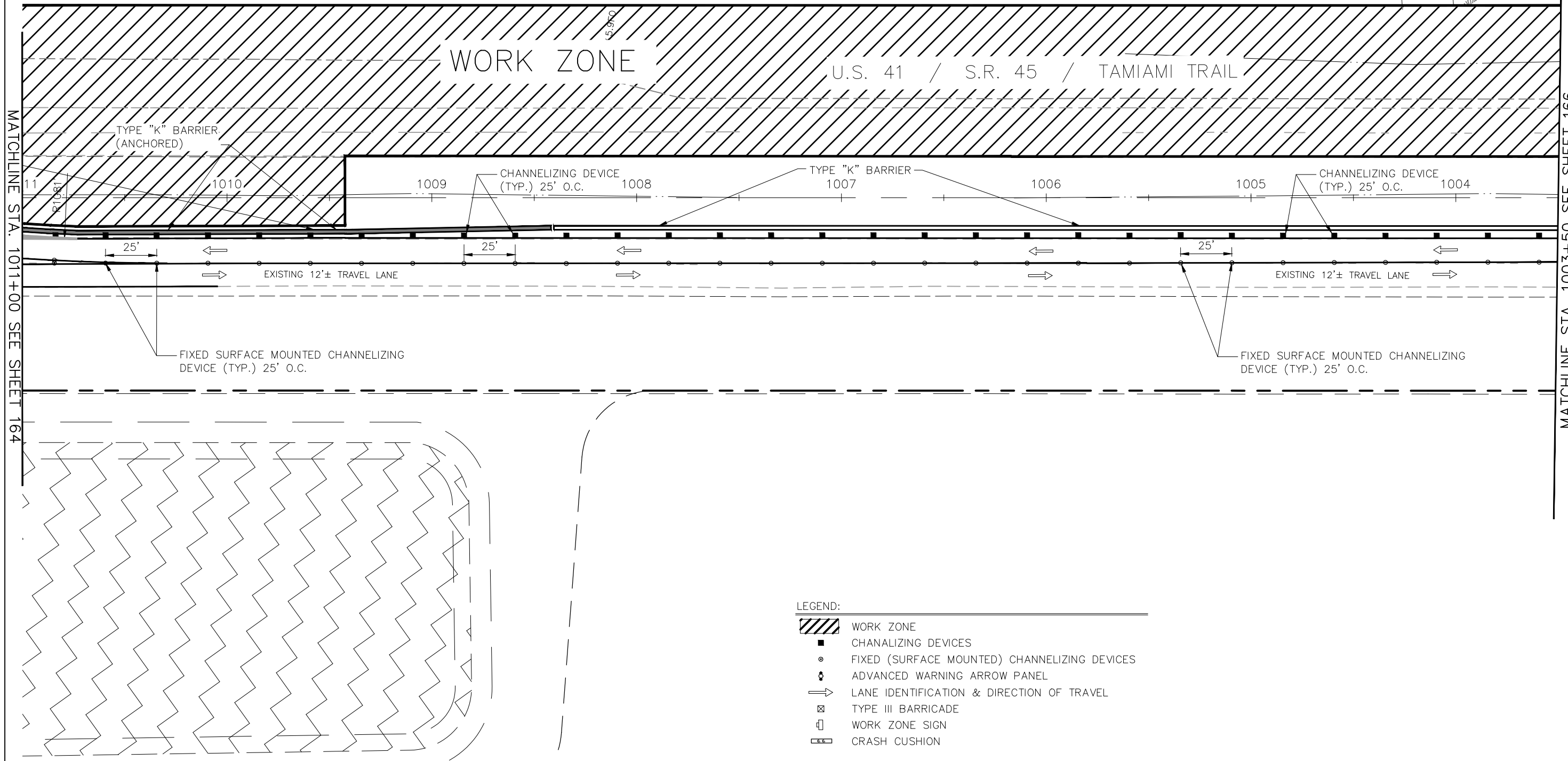

MATCHLINE STA. 1011+00 SEE SHEET 164

MATCHLINE STA. 1003+50 SEE SHEET 166

- LEGEND:
- WORK ZONE
 - CHANNELIZING DEVICES
 - FIXED (SURFACE MOUNTED) CHANNELIZING DEVICES
 - ADVANCED WARNING ARROW PANEL
 - LANE IDENTIFICATION & DIRECTION OF TRAVEL
 - TYPE III BARRICADE
 - WORK ZONE SIGN
 - CRASH CUSHION

REVISIONS				STANTEC CONSULTING SERVICES, INC. 6900 PROFESSIONAL PARKWAY EAST SARASOTA, FLORIDA 34240-8414 FBPE CERT. OF AUTH NO. 27013 KRISTOPHER A. WILHOIT, PE NO. 59549	STATE OF FLORIDA DEPARTMENT OF TRANSPORTATION			TEMPORARY TRAFFIC CONTROL PLAN PHASE 2	SHEET NO.
DATE	DESCRIPTION	DATE	DESCRIPTION		ROAD NO.	COUNTY	FINANCIAL PROJECT NO.		165
					###	"SARASOTA COUNTY"	215616466		

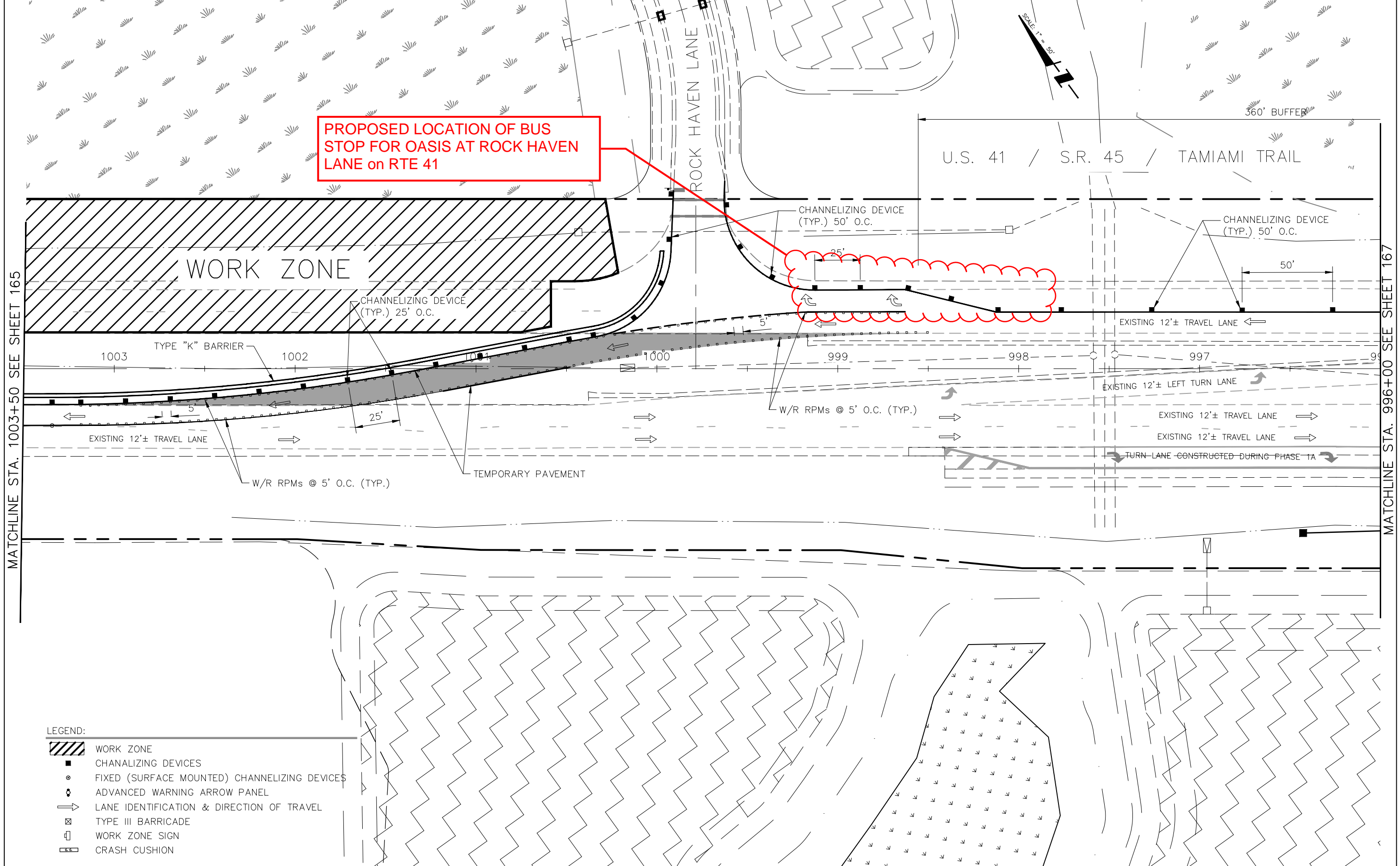

PROPOSED LOCATION OF BUS STOP FOR OASIS AT ROCK HAVEN LANE on RTE 41

- LEGEND:**
- WORK ZONE
 - CHANNELIZING DEVICES
 - FIXED (SURFACE MOUNTED) CHANNELIZING DEVICES
 - ADVANCED WARNING ARROW PANEL
 - LANE IDENTIFICATION & DIRECTION OF TRAVEL
 - TYPE III BARRICADE
 - WORK ZONE SIGN
 - CRASH CUSHION

REVISIONS		STANTEC CONSULTING SERVICES, INC. 6900 PROFESSIONAL PARKWAY EAST SARASOTA, FLORIDA 34240-8414 FBPE CERT. OF AUTH NO. 27013		STATE OF FLORIDA DEPARTMENT OF TRANSPORTATION		TEMPORARY TRAFFIC CONTROL PLAN PHASE 2	SHEET NO.	
DATE	DESCRIPTION	DATE	DESCRIPTION	ROAD NO.	COUNTY		FINANCIAL PROJECT NO.	166
				###	"SARASOTA COUNTY"		215616466	